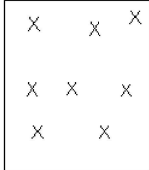

All India Trade Test - 2024 for Craftsmen Training Scheme (CTS)
Trade Name: Draughtsman Civil Year 2
Year: 2nd Year

Exam Date :
Exam Time :

- Note:
 1. Tick the correct option out of four alternatives provided
 2. All questions carry equal marks (2 Marks each)
 3. There is no negative marking

Sr. No.	Client Question ID	Question Body and Alternatives	Marks	Negative Marks
Trade Theory				
1	1	<p>What is the use of function key F3? फ़ंक्शन की F3 का उपयोग क्या है?</p> <p>A1 : OSNAP OSNAP</p> <p>A2 : TABLET TABLET</p> <p>A3 : ISOPLANE ISOPLANE</p> <p>A4 : SAVE AS SAVE AS</p>	2.0	0.00
Trade Theory				
2	2	<p>Which of the following software is limited for AutoCAD installation? निम्नलिखित में से कौन सा सॉफ्टवेयर AutoCAD इंस्टॉलेशन के लिए सीमित है?</p> <p>A1 : Windows DOS विंडोज DOS</p> <p>A2 : Windows 98 विंडोज 98</p> <p>A3 : Windows 03 विंडोज 03</p> <p>A4 : Windows 10 विंडोज 10</p>	2.0	0.00
Trade Theory				
3	3	<p>What is the name of the command from the figure given below? नीचे दिए गए आंकड़े से कमांड का नाम क्या है?</p> <div style="border: 1px solid black; padding: 10px; margin: 10px auto; width: fit-content;">  </div> <p>A1 : Star command स्टार कमांड</p>	2.0	0.00

A2 Array command
 : एरे कमांड
 A3 Point command
 : पॉइंट कमांड
 A4 Trim command
 : ट्रिम कमांड

Trade Theory

4 4

What is the name of the command in the figure given below?
 नीचे दिए गए आंकड़े में कमांड का नाम क्या है?

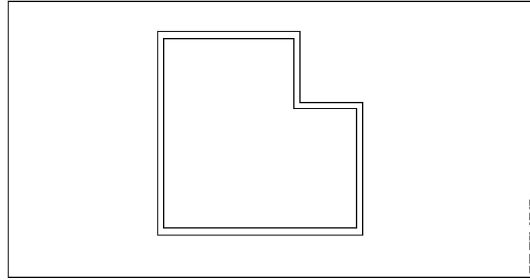

A1 Offset
 : ओफ़सेट
 A2 Construction line
 : कंस्ट्रक्शन
 A3 Multi line
 : मल्टी लाइन
 A4 P line
 : P लाइन

Trade Theory

5 5

What is the name of the command in the figure given below?
 नीचे दिए गए आंकड़े में कमांड का नाम क्या है?

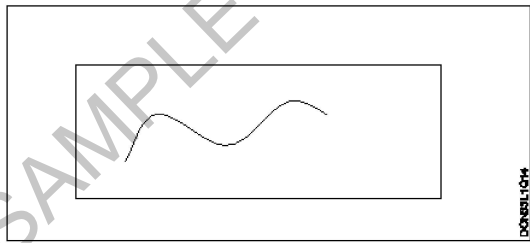

A1 P line
 : P लाइन
 A2 M line
 : M लाइन
 A3 Spline
 : एसपी लाइन
 A4 Poly line
 : पॉली लाइन

Trade Theory

6 6

What is the full form of UCS?
 UCS का पूर्ण रूप क्या है?

2.0 0.00

2.0 0.00

2.0 0.00

- A1
: User CAD System
User CAD System
- A2
: User CADD System
User CADD System
- A3
: User Co-ordinate System
User Co-ordinate System
- A4
: User Circle System
User Circle System

Trade Theory

7

7

What is the name of the point marked as 'x'?

'X' के रूप में चिह्नित बिंदु का नाम क्या है?

2.0

0.00

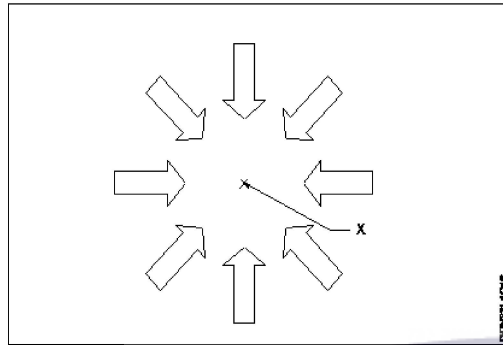

- A1
: Midpoint of dollar
डॉलर का मध्य बिंदु
- A2
: Midpoint of offset
ऑफसेट का मध्य बिंदु
- A3
: Centre point of array
एरे का केंद्र बिंदु
- A4
: Centre point of leader line
लीडर लाइन का केंद्र बिंदु

Trade Theory

8

8

Which shortcut key does the work of ortho?

कौन सी शॉर्टकट कुंजी ऑर्थो का काम करती है?

2.0

0.00

- A1
: F6
F6
- A2
: F7
F7
- A3
: F8
F8
- A4
: F9
F9

Trade Theory

9

9

Which shortcut key does the work of Redo last action?

Redo की अंतिम क्रिया कार्य की कौन सी शॉर्टकट कुंजी है?

2.0

0.00

- A1
: Ctrl + Z
Ctrl + Z

		<p>A2 Ctrl + Y : Ctrl + Y</p> <p>A3 Ctrl + C : Ctrl + C</p> <p>A4 Ctrl + X : Ctrl + X</p>		
Trade Theory				
10	10	<p>What is the use of shortcut key 'H'?</p> <p>शॉर्टकट की 'H' का उपयोग क्या है?</p> <p>A1 Help : हेल्प</p> <p>A2 B hatch : B हैच</p> <p>A3 Hatch : हैच</p> <p>A4 Hollow block : हॉलो ब्लॉक</p>	2.0	0.00
Trade Theory				
11	11	<p>What is the use of the shortcut key 'M Text'?</p> <p>शॉर्टकट कुंजी 'M टेक्स्ट' का उपयोग क्या है?</p> <p>A1 Modify text : मॉडिफाई टेक्स्ट</p> <p>A2 Move text : मूव टेक्स्ट</p> <p>A3 Multi text : मल्टी टेक्स्ट</p> <p>A4 Menu text : मेनू टेक्स्ट</p>	2.0	0.00
Trade Theory				
12	12	<p>What is the use of 'Q' shortcut key?</p> <p>'Q' शॉर्टकट कुंजी का उपयोग क्या है?</p> <p>A1 Quit : क्रिट</p> <p>A2 Quick calc : क्रिट कैल्क</p> <p>A3 Save as : सेव एस</p> <p>A4 "Q" leader : "Q" लीडर</p>	2.0	0.00
Trade Theory				
13	13	<p>Which of the following shortcut keys gives quick calc?</p> <p>निम्नलिखित में से कौन सी शॉर्टकट कुंजी क्रिट कैल्क देती है?</p> <p>A1 Ctrl + 6 : Ctrl + 6</p>	2.0	0.00

		<p>A2 Ctrl + 7 : Ctrl + 7</p> <p>A3 Ctrl + 8 : Ctrl + 8</p> <p>A4 Ctrl + 9 : Ctrl + 9</p>		
Trade Theory				
14	14	<p>Which of the following pointing device is cheaper while comparing the digitizer? डिजिटाइज़र की तुलना करते समय निम्नलिखित में से कौन सा पॉइंटिंग डिवाइस सस्ता है?</p> <p>A1 Key board : की बोर्ड</p> <p>A2 Puck : पक</p> <p>A3 Mouse : माउस</p> <p>A4 Enter key : इंटर की</p>	2.0	0.00
Trade Theory				
15	15	<p>Which of the following commands has one major option? निम्नलिखित कमांडों में से एक प्रमुख विकल्प है?</p> <p>A1 Line : लाइन</p> <p>A2 M line : M लाइन</p> <p>A3 P line : P लाइन</p> <p>A4 Polygon : पालीगोन</p>	2.0	0.00
Trade Theory				
16	16	<p>What is the extension for 3D modelling file? 3D मॉडलिंग फ़ाइल के लिए एक्सटेंशन क्या है?</p> <p>A1 0.3d : 0.3d</p> <p>A2 0.3dm : 0.3dm</p> <p>A3 0.3m : 0.3 m</p> <p>A4 0.3dmo : 0.3dmo</p>	2.0	0.00
Trade Theory				
17	17	<p>Which command allows you to change 2D drawing into 3D model? कौन सी कमांड आपको 2D ड्राइंग को 3D मॉडल में बदलने की अनुमति देती है?</p> <p>A1 3D modelling : 3 डी मॉडलिंग</p>	2.0	0.00

		<p>A2 Extrude : एक्सट्रुड</p> <p>A3 C plan : C प्लान</p> <p>A4 Ortho : ऑर्थो</p>		
Trade Theory				
18	18	<p>What is the full form of WCS? WCS का पूर्ण रूप क्या है?</p> <p>A1 Western Co- ordinate System : Western Co- ordinate System</p> <p>A2 World Co- ordinate System : World Co- ordinate System</p> <p>A3 Wide Co- ordinate System : Wide Co- ordinate System</p> <p>A4 Wrong Co-ordinate System : Wrong Co-ordinate System</p>	2.0	0.00
Trade Theory				
19	19	<p>What is the shortcut to cancel the last command selected? चयनित अंतिम कमांड को रद्द करने का शॉर्टकट क्या है?</p> <p>A1 Ctrl +] : Ctrl +]</p> <p>A2 Ctrl + [: Ctrl + [</p> <p>A3 Ctrl + } : Ctrl + }</p> <p>A4 Ctrl + , : Ctrl + ,</p>	2.0	0.00
Trade Theory				
20	20	<p>What is the shortcut for rendering an image? एक इमेज प्रदान करने के लिए शॉर्टकट क्या है?</p> <p>A1 RS : RS</p> <p>A2 RSP : RSP</p> <p>A3 RP : RP</p> <p>A4 RW : RW</p>	2.0	0.00
Trade Theory				
21	21	<p>What is the shortcut for rendering a specified part of drawing? ड्राइंग के निर्दिष्ट भाग को प्रस्तुत करने के लिए शॉर्टकट क्या है?</p> <p>A1 RB : RB</p>	2.0	0.00

		A2 RC : RC A3 RD : RD A4 RP : RP		
Trade Theory				
22	22	What is the area of playground for 1000 children? 1000 बच्चों के लिए खेल के मैदान का क्षेत्र क्या है? A1 0.10 hectare : 0.10 hectare A2 0.13 hectare : 0.13 hectare A3 0.16 hectare : 0.16 hectare A4 0.20 hectare : 0.20 hectare	2.0	0.00
Trade Theory				
23	23	Which one of the following is the hard landscape? निम्नलिखित में से कौन सा हार्ड लैंड स्केप है? A1 Plantation : पेड़ लगाना A2 Types of trees : पेड़ों के प्रकार A3 Design of space for people : लोगों के लिए जगह का डिजाइन A4 Terrace gardens : टेरेस गार्डन	2.0	0.00
Trade Theory				
24	24	In which portion of tectonic plates, earthquake generally occurs? टेक्टोनिक प्लेटों के किस भाग में, भूकंप आमतौर पर होता है? A1 Plate boundaries : प्लेट बाउंड्री A2 Divergence plates : डायवर्सन प्लेट्स A3 Converging plates : कंवरजिंग प्लेट्स A4 Middle portion : मध्य भाग	2.0	0.00
Trade Theory				
25	25	Which instrument is used to detect and record seismic waves? भूकंपीय तरंगों का पता लगाने और रिकॉर्ड करने के लिए किस उपकरण का उपयोग किया जाता है? A1 Barograph : बेरोग्राफ	2.0	0.00

		<p>A2 Seismograph : सीज्मोग्राफ</p> <p>A3 Diagraph : डायग्राफ</p> <p>A4 Hygrograph : हाइड्रोग्राफ</p>		
Trade Theory				
26	26	<p>Which is known as hypocenter? जिसे हाइपोसेंटर के नाम से जाना जाता है?</p> <p>A1 Epicenter : एपीसेंटर</p> <p>A2 Focus : फोकस</p> <p>A3 Focal depth : फोकल गहराई</p> <p>A4 Epicentral distance : एपीसेंटर दूरी</p>	2.0	0.00
Trade Theory				
27	27	<p>What is the percentage of the structural cost of the building in the additional cost for the earthquake resisting structure? भूकंप प्रतिरोध संरचना के लिए अतिरिक्त लागत में भवन की संरचनात्मक लागत का कितना प्रतिशत है?</p> <p>A1 About 1% : लगभग 1%</p> <p>A2 About 2% : लगभग 2%</p> <p>A3 About 3% : लगभग 3%</p> <p>A4 About 5% : लगभग 5%</p>	2.0	0.00
Trade Theory				
28	28	<p>What is the minimum thickness for making R.C. Bands? R.C बैंड बनाने के लिए न्यूनतम मोटाई क्या है।</p> <p>A1 25mm : 25mm</p> <p>A2 50mm : 50mm</p> <p>A3 75mm : 75mm</p> <p>A4 100mm : 100mm</p>	2.0	0.00
Trade Theory				
29	29	<p>What is the distance between two through stones? दो थ्रो स्टोन के बीच की दूरी होती है?</p> <p>A1 150 to 300mm : 150 to 300mm</p>	2.0	0.00

		<p>A2 : 300 to 450mm 300 to 450mm</p> <p>A3 : 450 to 600mm 450 to 600mm</p> <p>A4 : 600 to 750mm 600 to 750mm</p>		
Trade Theory				
30	30	<p>Which one of the following in structure is the most important factors affecting its earthquake performance? संरचना में निम्नलिखित में से कौन सा सबसे महत्वपूर्ण कारक है जो इसके भूकंप के प्रदर्शन को प्रभावित करता है?</p> <p>A1 : Workability वर्कबिलिटी</p> <p>A2 : Serviceability उपयुक्तता</p> <p>A3 : Flexibility लचीलापन</p> <p>A4 : Responsibility ज़िम्मेदारी</p>	2.0	0.00
Trade Theory				
31	31	<p>Which precaution should be taken for site selection to prevent earthquake? भूकंप को रोकने के लिए स्थल चयन के लिए कौन सी सावधानी बरती जानी चाहिए?</p> <p>A1 : Near unstable embankments अस्थिर तटबंधों के पास</p> <p>A2 : On sloping ground झुकी हुई जमीन पर</p> <p>A3 : Columns of different height विभिन्न ऊंचाई के स्तंभ</p> <p>A4 : Continuity of subsoil सबसाइल की निरंतरता</p>	2.0	0.00
Trade Theory				
32	32	<p>Which shape of building plan is safer for earthquake resisting building? भवन निर्माण योजना का कौन सा आकार भूकंप के विरोध में सुरक्षित है?</p> <p>A1 : Square plan वर्गकार प्लान</p> <p>A2 : T- shaped plan T- आकार का प्लान</p> <p>A3 : H- shaped plan H-आकार का प्लान</p> <p>A4 : Plan have length more than twice the width प्लान की लंबाई मोरीथन की चौड़ाई से दोगुनी</p>	2.0	0.00
Trade Theory				
33	33	<p>What is the name of the figure? आकृति का नाम क्या है?</p>	2.0	0.00

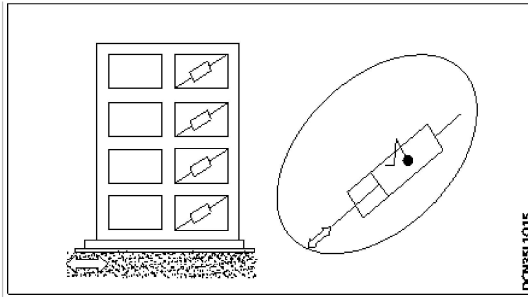

A1 Isolation bearings

: आइसोलेशन बीयरिंग

A2 Viscous damper

: विसकस डेम्पर

A3 Friction damper

: घर्षण डेम्पर

A4 Yielding damper

: यील्डिंग डेम्पर

Trade Theory

34	34	Which device act like shock absorbers between the building and its foundation? भवन और इसकी नींव के बीच कौन सा उपकरण शॉक अवशोषक की तरह काम करता है?	2.0	0.00
----	----	---	-----	------

A1 Damper

: डेम्पर

A2 Spring

: स्प्रिंग

A3 Base isolation

: बेस आइसोलेशन

A4 Air bag

: एयर बैग

Trade Theory

35	35	Which isolation bearings are highly elastic? कौन सी आइसोलेशन बीयरिंग अत्यधिक लोचदार हैं?	2.0	0.00
----	----	---	-----	------

A1 Wood

: लकड़ी

A2 Steel

: इस्पात

A3 Rubber

: रबर

A4 Bearing pads

: बियरिंग पैड

Trade Theory

36	36	Which of the following option is taken, if the phone line system will be jammed after earth quake? निम्नलिखित में से कौन सा विकल्प लिया जाता है, अगर धरती के भूकंप के बाद फोन लाइन सिस्टम जाम हो जाएगा?	2.0	0.00
----	----	--	-----	------

A1 Text messages

: मूल संदेश

A2 Call loudly

: Call loudly

		<p>कॉल लाउडली</p> <p>A3 : Call through phone</p> <p>फोन के जरिए बुलाना</p> <p>A4 : Whats app call</p> <p>व्हाट्स एप कॉल</p>		
Trade Theory				
37	37	<p>Which of the following operation need to be done during earthquake? भूकंप के दौरान निम्नलिखित में से कौन सा ऑपरेशन करने की आवश्यकता है?</p> <p>A1 : Standing near the window</p> <p>खिड़की के पास खड़ा होना</p> <p>A2 : Collect and put together an emergency kit</p> <p>कोलेट और एक आपातकालीन किट को एक साथ रखा</p> <p>A3 : Check your gas lines</p> <p>अपनी गैस लाइनों की जाँच करें</p> <p>A4 : Cover and hold on under a desk/table</p> <p>कवर और होल्ड डेस्क/ टेबल पर</p>	2.0	0.00
Trade Theory				
38	38	<p>Which material is strong in tensile strength? तन्य शक्ति में कौन सा पदार्थ मजबूत है?</p> <p>A1 : Cement</p> <p>सीमेंट</p> <p>A2 : Sand</p> <p>रेत</p> <p>A3 : Steel</p> <p>इस्पात</p> <p>A4 : Water</p> <p>पानी</p>	2.0	0.00
Trade Theory				
39	39	<p>What kind of material is concrete? कंक्रीट किस तरह का पदार्थ है?</p> <p>A1 : Elasticity</p> <p>इलासटिसिटी</p> <p>A2 : Brittle</p> <p>ब्रिटल</p> <p>A3 : Stiff</p> <p>कठोर</p> <p>A4 : Malleability</p> <p>मेलीएबिलिटी</p>	2.0	0.00
Trade Theory				
40	40	<p>What is the maximum size of particle in fine aggregate? फाइन एग्रीगेट में कण का अधिकतम आकार क्या है?</p> <p>A1 : 2.75 mm</p> <p>2.75 mm</p> <p>A2 : 3.75 mm</p> <p>3.75 mm</p>	2.0	0.00

		3.75 mm A3 : 4.75 mm 4.75 mm A4 : 5.75 mm 5.75 mm		
Trade Theory				
41	41	What is the ratio for M15 grade of concrete? कंक्रीट के M15 ग्रेड के लिए अनुपात क्या है? A1 : 1:3:6 1:3:6 A2 : 1:2:4 1:2:4 A3 : 1:1.5:3 1:1.5:3 A4 : 1:1:2 1:1:2	2.0	0.00
Trade Theory				
42	42	What is the PH value of water is used for concrete? कंक्रीट के लिए पानी का PH मान कितना उपयोग किया जाता है? A1 : 2 and 3 2 और 3 A2 : 4 and 5 4 और 5 A3 : 6 and 8 6 और 8 A4 : 9 and 10 9 और 10	2.0	0.00
Trade Theory				
43	43	What is the maximum absorption limit for coarse aggregate under water for 24 hours? 24 घंटे के लिए पानी के अंदर मोटे एग्रीगेट के लिए अधिकतम अवशोषण सीमा क्या है? A1 : 3% 3% A2 : 5% 5% A3 : 7% 7% A4 : 9% 9%	2.0	0.00
Trade Theory				
44	44	When does the probs of slab is removed if the span is more than 4.5 m? यदि स्पेन 4.5 m से अधिक हो तो स्लैब के प्रोब्स को कब हटा दिया जाता है? A1 : 7 days 7 दिन A2 : 14 days 14 दिन	2.0	0.00

		<p>A3 21 days : 21 दिन</p> <p>A4 28 days : 28 दिन</p>		
Workshop Calculation Science				
45	45	<p>What is the radius of a circle whose diameter is 44 cm? वृत्त की त्रिज्या क्या है जिसका व्यास 44cm है?</p> <p>A1 44 cm : 44 cm</p> <p>A2 22 cm : 22 cm</p> <p>A3 23 cm : 23 cm</p> <p>A4 20 cm : 20 cm</p>	2.0	0.00
Workshop Calculation Science				
46	46	<p>What is the value of x if $13+x=20$? यदि $13+x = 20$ है तो x का मान क्या है?</p> <p>A1 8 : 8</p> <p>A2 7 : 7</p> <p>A3 9 : 9</p> <p>A4 13 : 13</p>	2.0	0.00
Workshop Calculation Science				
47	47	<p>What is the formula for $a^m \times a^n$? $a^m \times a^n$ के लिए फार्मूला क्या है?</p> <p>A1 a^{m+n} : a^{m+n}</p> <p>A2 a^{m-n} : a^{m-n}</p> <p>A3 a^{mn} : a^{mn}</p> <p>A4 $n.a^m$: $n.a^m$</p>	2.0	0.00
Workshop Calculation Science				
48	48	<p>Which is equal to $(a^m)^n$? $(a^m)^n$ किसके बराबर हो।</p> <p>A1 a^{m-n} : a^{m-n}</p> <p>A2 a^{m+n} : a^{m+n}</p>	2.0	0.00

		A3 $a^{m/n}$: $a^{m/n}$ A4 a^{mn} : a^{mn}		
Workshop Calculation Science				
49	49	What is the expanded form of $(a+b)^2$? $(a+b)^2$ का विस्तारित रूप क्या है? A1 $a^2 + 2ab + b^2$: $a^2 + 2ab + b^2$ A2 $a^2 - 2ab + b^2$: $a^2 - 2ab + b^2$ A3 $a^2 + 2ab - b^2$: $a^2 + 2ab - b^2$ A4 $-a^2 - 2ab + b^2$: $-a^2 - 2ab + b^2$	2.0	0.00
Workshop Calculation Science				
50	50	What is the formula for $(a-b)^2$? $(a-b)^2$ का सूत्र क्या है? A1 $a^2 - 2ab + b^2$: $a^2 - 2ab + b^2$ A2 $a^2 + 2ab + b^2$: $a^2 + 2ab + b^2$ A3 $a^2 - 2ab - b^2$: $a^2 - 2ab - b^2$ A4 $-a^2 - 2ab - b^2$: $-a^2 - 2ab - b^2$	2.0	0.00
Employability Skills				
51	51	Complete the sentence with suitable describing words It is a _____ neighbourhood. One need not fear. Complete the sentence with suitable describing words It is a _____ neighbourhood. One need not fear. A1 good : good A2 big : big A3 safe : safe A4 expensive : expensive	2.0	0.00
Employability Skills				
52	52	Complete the sentence with suitable describing words There isn't any amusement park in the area. It is a ___ place. Complete the sentence with suitable describing words There isn't any amusement park in the area. It is a ___ place. A1 polluted : polluted A2 dry : dry	2.0	0.00

		<p>A3 : noisy</p> <p>noisy</p> <p>A4 : boring</p> <p>boring</p>		
Employability Skills				
53	53	<p>Complete the sentence with suitable describing words There is a factory in the area. The air is _____.</p> <p>Complete the sentence with suitable describing words There is a factory in the area. The air is _____.</p> <p>A1 : polluted</p> <p>polluted</p> <p>A2 : boring</p> <p>boring</p> <p>A3 : uneven</p> <p>uneven</p> <p>A4 : noisy</p> <p>noisy</p>	2.0	0.00
Employability Skills				
54	54	<p>Complete the sentence with suitable describing words There is water scarcity in the locality. The area is _____.</p> <p>Complete the sentence with suitable describing words There is water scarcity in the locality. The area is _____.</p> <p>A1 : uneven</p> <p>uneven</p> <p>A2 : noisy</p> <p>noisy</p> <p>A3 : dry</p> <p>dry</p> <p>A4 : boring</p> <p>boring</p>	2.0	0.00
Employability Skills				
55	55	<p>Complete the sentence with suitable describing words The transportation to some rural areas is difficult as the roads are _____.</p> <p>Complete the sentence with suitable describing words The transportation to some rural areas is difficult as the roads are _____.</p> <p>A1 : dry</p> <p>dry</p> <p>A2 : polluted</p> <p>polluted</p> <p>A3 : boring</p> <p>boring</p> <p>A4 : uneven</p> <p>uneven</p>	2.0	0.00
Employability Skills				
56	56	<p>What help us to maintain the balance between mental and physical activities?</p> <p>What help us to maintain the balance between mental and physical activities?</p> <p>A1 : Hobbies</p> <p>Hobbies</p> <p>A2 : Running</p> <p>Running</p>	2.0	0.00

		<p>A3 Walking : Walking</p> <p>A4 Reading : Reading</p>		
Employability Skills				
57	57	<p>When you meet the instructor inside or outside the ITI, it is.... When you meet the instructor inside or outside the ITI, it is....</p> <p>A1 always formal : always formal</p> <p>A2 . formal inside the ITI : . formal inside the ITI</p> <p>A3 informal the ITI : informal the ITI</p> <p>A4 informal outside : informal outside</p>	2.0	0.00
Employability Skills				
58	58	<p>Role models _____ people to follow them Role models _____ people to follow them</p> <p>A1 elevate : elevate</p> <p>A2 instruct : instruct</p> <p>A3 inspire : inspire</p> <p>A4 motivate : motivate</p>	2.0	0.00
Employability Skills				
59	59	<p>Spoken communication is usually not only _____ but also _____ Spoken communication is usually not only _____ but also _____</p> <p>A1 formal, informal : formal, informal</p> <p>A2 verbal, nonverbal : verbal, nonverbal</p> <p>A3 verbal, informal : verbal, informal</p> <p>A4 formal, nonverbal : formal, nonverbal</p>	2.0	0.00
Employability Skills				
60	60	<p>The immediate surroundings to the place you live in is called _____ The immediate surroundings to the place you live in is called _____</p> <p>A1 village : village</p> <p>A2 town : town</p> <p>A3 city : city</p>	2.0	0.00

		city A4 neighbourhood : neighbourhood		
Employability Skills				
61	61	The conditions in a place that affect the behaviour and development of somebody or something is called _____ The conditions in a place that affect the behaviour and development of somebody or something is called _____ A1 neighbourhood : neighbourhood A2 environment : environment A3 locality : locality A4 facilities : facilities	2.0	0.00
Employability Skills				
62	62	Which kind of persons are with very good behaviour, achievements and lead as an example? Which kind of persons are with very good behaviour, achievements and lead as an example? A1 customer service executives : customer service executives A2 ITI instructors : ITI instructors A3 role models : role models A4 sales supervisors : sales supervisors	2.0	0.00
Employability Skills				
63	63	There ----- a coffee shop -----the park. There ----- a coffee shop -----the park. A1 are, next to : are, next to A2 is, next to : is, next to A3 is, next : is, next A4 are, next : are, next	2.0	0.00
Employability Skills				
64	64	Rainwater harvesting ----- to prevent water scarcity Rainwater harvesting ----- to prevent water scarcity A1 gives : gives A2 gave : gave A3 help : help	2.0	0.00

		A4 helps : helps		
Employability Skills				
65	65	Identify the opposites. clean x -----, healthy x ----- Identify the opposites. clean x -----, healthy x ----- A1 dirty, health : dirty, health A2 . dirty, healthy : . dirty, healthy A3 dirt, unhealthy : dirt, unhealthy A4 dirty, unhealthy : dirty, unhealthy	2.0	0.00
Employability Skills				
66	66	Which one is not an adventure? Which one is not an adventure? A1 climbing mountains : climbing mountains A2 trekking : trekking A3 surfing : surfing A4 driving : driving	2.0	0.00
Employability Skills				
67	67	Travelling in the sea is called a _____ Travelling in the sea is called a _____ A1 voyage : voyage A2 boating : boating A3 fishing : fishing A4 tour : tour	2.0	0.00
Employability Skills				
68	68	There are many dos and don'ts to be -----while preparing for/ attending an _____ There are many dos and don'ts to be -----while preparing for/ attending an _____ A1 there, interview : there, interview A2 identify, : identify, A3 identified, interviewed : identified, interviewed A4 identified, interview : identified, interview	2.0	0.00

		identified, interview		
Employability Skills				
69	69	<p>Always ----- your mobile phone ----- silent mode. Always ----- your mobile phone ----- silent mode.</p> <p>A1 : know, in know, in</p> <p>A2 : know, of know, of</p> <p>A3 : keep, in keep, in</p> <p>A4 : keep, of keep, of</p>	2.0	0.00
Employability Skills				
70	70	<p>The Everest, the ----- peak in the world, ----- in Tibet. The Everest, the ----- peak in the world, ----- in Tibet.</p> <p>A1 : high, is high, is</p> <p>A2 : higher, is higher, is</p> <p>A3 : highest, are highest, are</p> <p>A4 : highest, is highest, is</p>	2.0	0.00
Employability Skills				
71	71	<p>Which language is essential to become a Computer professional? Which language is essential to become a Computer professional?</p> <p>A1 : Mother tongue Mother tongue</p> <p>A2 : Chinese Chinese</p> <p>A3 : English English</p> <p>A4 : Hindi Hindi</p>	2.0	0.00
Employability Skills				
72	72	<p>Which is the Synonym for "loyal"? Which is the Synonym for "loyal"?</p> <p>A1 : Faithful Faithful</p> <p>A2 : Prosperous Prosperous</p> <p>A3 : Utopian Utopian</p> <p>A4 : Perfect Perfect</p>	2.0	0.00
Employability Skills				

73	73	<p>When you speak to your supervisor, you should be _____.</p> <p>When you speak to your supervisor, you should be _____.</p> <p>A1 Aggressive : Aggressive</p> <p>A2 Formal : Formal</p> <p>A3 Informal : Informal</p> <p>A4 Casual : Casual</p>	2.0	0.00
Employability Skills				
74	74	<p>Which one is the describing word from among the words given?</p> <p>Which one is the describing word from among the words given?</p> <p>A1 Mobile phone : Mobile phone</p> <p>A2 Water : Water</p> <p>A3 Pull : Pull</p> <p>A4 Magnificent : Magnificent</p>	2.0	0.00
Employability Skills				
75	75	<p>A _____ sentence is a sentence that expresses a direct , command, invitations, warning or instruction.</p> <p>A _____ sentence is a sentence that expresses a direct , command, invitations, warning or instruction.</p> <p>A1 simple : simple</p> <p>A2 compound : compound</p> <p>A3 imperative : imperative</p> <p>A4 adjective : adjective</p>	2.0	0.00

Draughtsman Civil -2nd year (Eng) SET 2

Question Number	Correct Alternative position
1	A1
2	A4
3	A3
4	A3
5	A3
6	A3
7	A3
8	A3
9	A2
10	A3
11	A3
12	A3
13	A3
14	A3
15	A3
16	A2
17	A2
18	A2
19	A1
20	A3
21	A2
22	A2
23	A3
24	A1
25	A2
26	A2
27	A4
28	A3
29	A4
30	A3
31	A4
32	A1
33	A2
34	A3
35	A3
36	A1
37	A4
38	A3
39	A2
40	A3
41	A2
42	A3
43	A2
44	A2
45	A2

46	A2
47	A1
48	A4
49	A1
50	A1
51	A3
52	A4
53	A1
54	A3
55	A4
56	A1
57	A1
58	A3
59	A2
60	A4
61	A2
62	A3
63	A2
64	A4
65	A4
66	A4
67	A1
68	A4
69	A3
70	A4
71	A3
72	A1
73	A2
74	A4
75	A3

KEY ANSWER SET 2